

EXISTING ARRANGEMENT
Scale 1:200

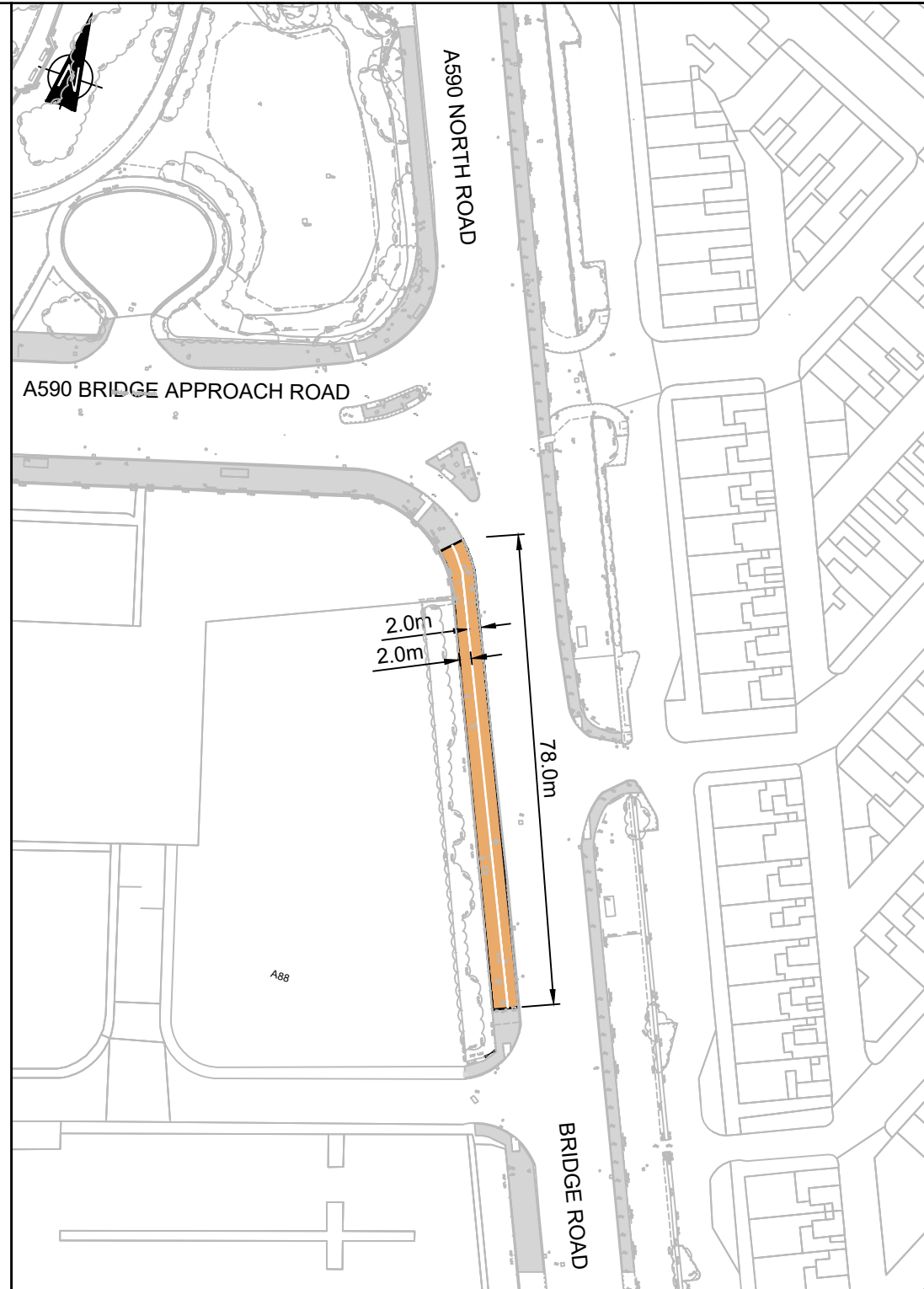

PROPOSED ARRANGEMENT
Scale 1:200

DO NOT SCALE

KEY

- EXISTING PEDESTRIAN FOOTWAY
- PROPOSED SHARED SURFACE WITH SEGREGATED CYCLE LANE AND PEDESTRIAN FACILITY

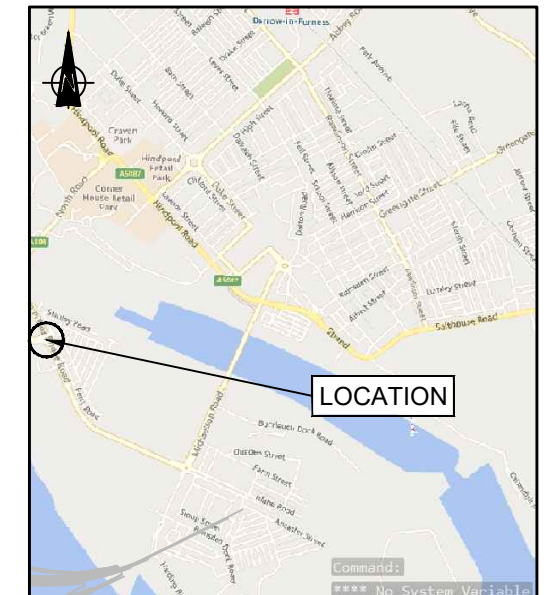

LOCATION PLAN
N.T.S

P01	17/10/2022	CM	FIRST ISSUE	AA	MB
REV	DATE	BY	DESCRIPTION	CHK	APP
DRAWING STATUS: S2 - FOR INFORMATION					

wsp

WSP Global Inc. 1st Floor, Exchange Station, Tithebarn Street,
Liverpool L2 2QP
T+ 44 (0) 151 331 8100
wsp.com

CLIENT:
CUMBRIA COUNTY COUNCIL

ARCHITECT:
WSP

PROJECT:
**BARROW ACTIVE TRAVEL FUND
BRIDGE ROAD AND MICHAELSON ROAD CYCLEWAY**

TITLE:
SECTION 65 & 66 FOOTWAY CONVERSION NOTICE

SCALE @ A3: 1:200	CHECKED: AA	APPROVED: MB
PROJECT No: 70082797	DESIGNED: AA	DRAWN: CM
DATE: November 22		REV: P01
DRAWING No: 70082797-WSP-HGN-BR-SK-10		
© WSP UK Ltd		