





Key

-  Proposed 30mph to replace existing National Speed Limit
-  Existing 30mph Speed Limit
-  Existing National Speed Limit

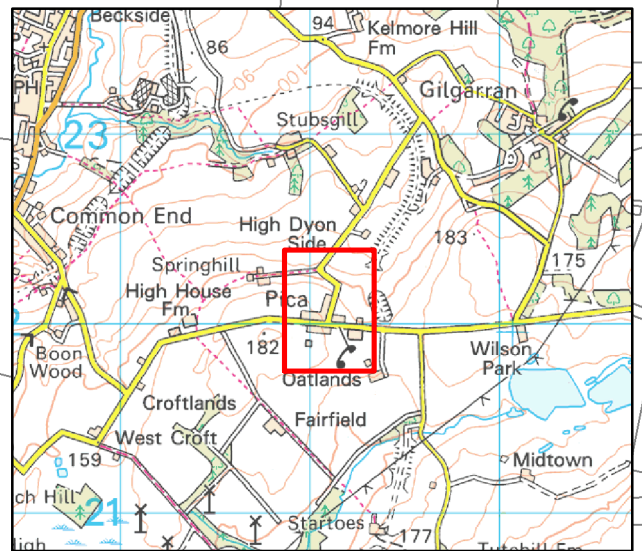
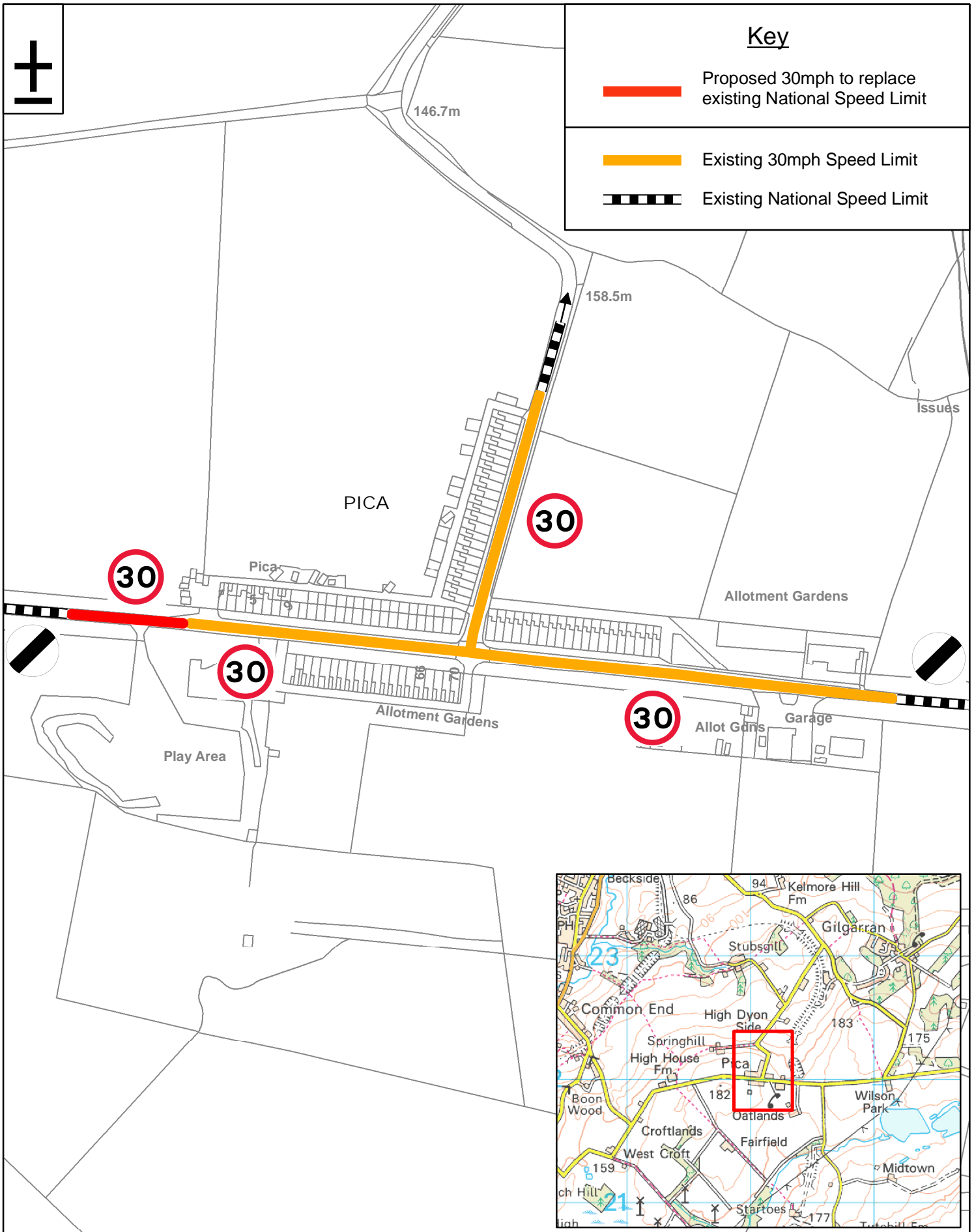

Grid Ref: 301943 / 522027

Speed Limit Review



Highways Depot, Joseph Noble Road,
Lillyhall Industrial Estate, Workington CA14 4JH

Proposal No. 2 Pica

Drawing No: SLR/23-24/P02/AM0

This produce includes mapping data licensed from Ordnance Survey.
(c) Crown Copyright 2023.
License Number 100066931

Drawn By: MJR

Scale: NTS

Date: 19/09/23